

## Standard Ballasts 18–58 W, 230 V

For compact fluorescent lamps  
Shape: 28 x 41 mm

Vacuum-impregnated with polyester resin

Push-in terminal for leads: 0.5–1 mm<sup>2</sup>

For the automatic luminaire wiring:

IDC terminals for leads H05V-U 0.5

tw 130

Protection class I

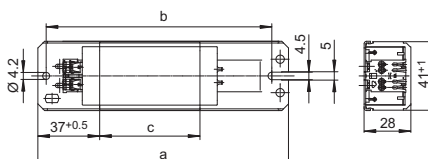
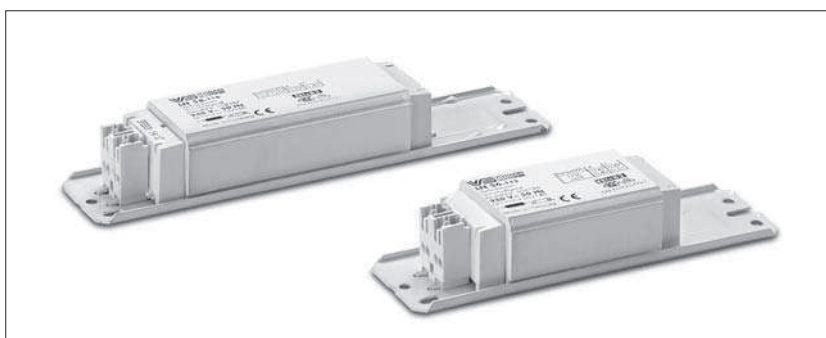

Lamp				Ballast									Capacitor	
Output	Type	Base	Current	Type	Ref. No.	Voltage	a	b	c	Weight	Δt/Δtan.	Energy efficiency*	C <sub>p</sub>	Current
W			mA			V, Hz	mm	mm	mm	kg	K		μF	mA
<b>230 V, 50 Hz</b>														
18	TC-D/TC-T	G24d-2/GX24d-2	220	LN 181.940	<b>508922</b>	230, 50	85	75	34	0.32	50/120	B1	2.0	110
				LN 181.319	<b>163763</b>	230, 50	85	75	34	0.32	60/140	B1	2.0	110
	TC-F/TC-L	2G10/2G11	370	LN 18.510	<b>164572</b>	230, 50	155	140	92	0.80	40/65	B1	4.5	120
				LN 18.131	<b>530941</b>	230, 50	150	140	60	0.55	55/95	B2	4.5	120
	T-U	2G13	370	L 18.934**	<b>534621</b>	230, 50	150	140	45	0.43	70/150	–	4.5	120
				LN 18.131	<b>530941</b>	230, 50	150	140	60	0.55	55/95	B2	4.5	120
2x18	TC-F/TC-L	2G10/2G11	400	LN 2x18.135	<b>532155</b>	230, 50	150	140	45	0.43	65	B1	4.0	210
				L 36.334	<b>530007</b>	230, 50	150	140	60	0.55	60/155	B1	4.0	210
22	T-R	G10q	400	LN 30.530	<b>164680</b>	230, 50	155	140	92	0.80	45/65	B2	4.5	200
24	TC-F/TC-L	2G10/2G11	345	LN 24/26.804	<b>534490</b>	230, 50	150	140	60	0.55	55/110	B2	4.5	150
				L 18.934**	<b>534621</b>	230, 50	150	140	45	0.43	70/150	–	4.5	150
26	TC-D/TC-T	G24d-3/GX24d-3	325	LN 18.131	<b>530941</b>	230, 50	150	140	60	0.55	55/95	B1	3.5	140
				LN 26.813	<b>509502</b>	230, 50	110	100	45	0.41	55/145	B2	3.5	140
				L 18.934**	<b>534621</b>	230, 50	150	140	45	0.43	70/150	–	3.5	140
28	TC-DD	GR8/GR10q	320	LN 18.510	<b>164572</b>	230, 50	155	140	92	0.80	40/65	B1	3.5	150
				LN 18.131	<b>530941</b>	230, 50	150	140	60	0.55	55/95	B1	3.5	150
				L 18.934**	<b>534621</b>	230, 50	150	140	45	0.43	70/150	–	3.5	150
<b>new</b> 32	T-R	G10q	450	LN 36.570	<b>169779</b>	230, 50	155	140	92	0.80	35/90	B2	4.0	220
36	TC-F/TC-L	2G10/2G11	430	LN 36.570	<b>169779</b>	230, 50	155	140	92	0.80	35/90	B1	4.5	210
				LN 36.511	<b>164590</b>	230, 50	155	140	92	0.80	35/95	B1	4.5	210
				LN 36.130	<b>527191</b>	230, 50	150	140	60	0.55	50/140	B2	4.5	210
				LN 36.149	<b>529029</b>	230, 50	150	140	60	0.55	55/150	B2	4.5	210
				L 36.132**	<b>535977</b>	230, 50	150	140	45	0.43	65	–	4.5	210
36/40	T-U/T-R	2G13/G10q	430	LN 36.570	<b>169779</b>	230, 50	150	140	92	0.80	35/90	B1	4.5	210
				LN 36.149	<b>529029</b>	230, 50	150	140	60	0.55	55/150	B2	4.5	210
				L 36.132**	<b>535977</b>	230, 50	150	140	45	0.43	65	–	4.5	210
38	TC-DD	GR10q	430	LN 36.570	<b>169779</b>	230, 50	155	140	92	0.80	35/90	B1	4.5	210
				LN 36.149	<b>529029</b>	230, 50	150	140	60	0.55	55/150	B2	4.5	210
				L 36.132**	<b>535977</b>	230, 50	150	140	45	0.43	65	–	4.5	210
<b>new</b> 58	T-U	2G13	670	LN 58.568	<b>169389</b>	230, 50	233	220	160	1.31	35/95	B1	7.0	320
				LN 58.990	<b>509349</b>	230, 50	190	180	110	0.95	50/130	B2	7.0	320
				LN 58.116	<b>508186</b>	230, 50	190	180	92	0.80	55/160	B2	7.0	320
				L 58.718**	<b>169658</b>	230, 50	190	180	92	0.80	60/170	–	7.0	320

\* Energy efficiency: EEI=B2 and EEI=B1, valid until 2017

\*\* Ballasts without CE mark for markets outside of the EU

1

2

3

4

5

6

7

8

9

10