

Spacing isolator Type DB/P



Made of Polyglas-polyester material, reinforced with fiberglass, colour red, self extinguishing. The isolators of type DB are unbreakable and have excellent electrical and mechanical characteristics and can be used under extreme working conditions such as high room temperatures, also when in contact with corrosive substances, vibrations, etc.

The hexagon, arranged middle layer with two facing sides, facilitates the connection and locking in place the isolator.

Upon request, the isolators can be supplied as follows:

- The isolator can be equipped with a thread which is not standard
- The isolator can be supplied with one or two threaded bolts „GB“

Operating temperature: $-40^{\circ}\text{C} < T < +130^{\circ}\text{C}$

Fire resistance class: UL 94-V0

All products are also available with matching threaded bolts.
Please contact us.

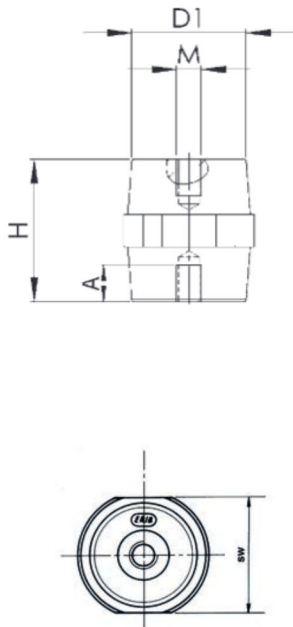

Art.-no.	Type	H [mm]	sw* [mm]	D1 [mm]	U _M [V]	M	A [mm]	Colour	Pac [pcs.]
90015	DB/P 12	12	11	10	220	M3	3	black	100
90018	DB/P 12	12	11	10	220	M4	3	red	100
90022	DB/P 16	16	14	13	380	M4	4	red	100
90025	DB/P 20	20	17	15	500	M4	6	red	100
90026	DB/P 20	20	17	15	500	M6	6	red	100
90028	DB/P 25	25	19	15	600	M6	7	black	250
90029	DB/P 25	25	19	15	600	M5	7	red	250
90030	DB/P 25	25	19	15	600	M6	7	red	250
90033	DB/P 30	30	30	26	600	M6	8	red	80
90034	DB/P 30	30	30	26	600	M8	7	red	80
90035	DB/P 34	35	32	28	0	M6	9	red	64
90036	DB/P 34	35	32	28	0	M8	10	red	64
90037	DB/P 34	35	32	28	0	M10	10	red	64
90038	DB/P 35	35	41	35	0	M6	9	red	36
90039	DB/P 35	35	41	35	0	M8	9	red	36
90040	DB/P 35	35	41	35	0	M10	10	red	36
90438	DB/P 40	40	40	30	0	M8	11	red	100
90439	DB/P 40	40	40	30	0	M10	12	red	100
90440	DB/P 40	40	40	30	0	M12	10	red	100
90041	DB/P 45	45	41	35	1500	M6	12	red	27
90042	DB/P 45	45	41	35	1500	M8	12	red	27
90043	DB/P 45	45	41	35	1500	M10	12	red	27
90044	DB/P 45	45	41	35	1500	M12	12	red	27
90046	DB/P 50	51	36	29	2000	M8	12	red	36
90047	DB/P 50	51	36	29	2000	M10	12	red	36
90048	DB/P 50	51	36	29	2000	M12	13	red	36
90441	DB/P 60	60	55	40	2000	M8	20	red	25
90442	DB/P 60	60	55	40	2000	M10	21	red	25
90443	DB/P 60	60	55	40	2000	M12	20	red	25
90050	DB/P 65	63,5	41	35	3000	M8	17	red	22
90051	DB/P 65	63,5	41	35	3000	M10	19	red	22
90052	DB/P 65	63,5	41	35	3000	M12	19	red	22
90053	DB/P 75	76	50	36	5000	M8	19	red	12
90054	DB/P 75	76	50	36	5000	M10	19	red	12
90055	DB/P 75	76	50	36	5000	M12	19	red	12
90057	DB/P 750	75	65	52	5000	M12	18	red	8
90058	DB/P 750	75	65	52	5000	M16	23	red	8

*sw=wrench width

Type	Thread	Ripple current resistance [kV]	Discharge voltage [kV]	Max. tensile load [kN]	Max. bending load [kN]	Max. compression load [kN]	Max. tightening torque [Nm]
DB/P 16	M4	3	8	1	0,5	5	2,8
DB/P 20	M4	4	15	1,5	0,6	6	2,8
DB/P 20	M6	4	15	1,5	0,6	6	8,9
DB/P 25	M5	7	20	3	1,8	21	5,1
DB/P 25	M6	7	20	3	1,8	21	8,9
DB/P 30	M6	8	23	5	2,5	44	8,9
DB/P 30	M8	8	23	5	2,5	44	21,5
DB/P 34	M6	10	30	8	4,5	65	8,9
DB/P 34	M8	10	30	8	4,5	65	21,5
DB/P 34	M10	10	30	8	4,5	65	43,0
DB/P 35	M6	10	30	11	8	80	8,9
DB/P 35	M8	10	30	11	8	80	21,5
DB/P 45	M6	12	40	12	8	80	8,9
DB/P 45	M8	12	40	12	8	80	21,5
DB/P 45	M10	12	40	12	8	80	43,0
DB/P 45	M12	12	40	12	8	80	85,0
DB/P 50	M8	12	40	8,5	4,5	68	21,5
DB/P 50	M10	12	40	8,5	4,5	68	43,0
DB/P 50	M12	12	40	8,5	4,5	68	85,0
DB/P 65	M8	15	40	15	7	83	21,5
DB/P 65	M10	15	40	15	7	83	43,0
DB/P 65	M12	15	40	15	7	83	85,0
DB/P 75	M8	25	50	23	9	100	21,5
DB/P 75	M10	25	50	23	9	100	43,0
DB/P 75	M12	25	50	23	9	100	85,0
DB/P 750	M12	25	50	28	15	150	85,0
DB/P 750	M16	25	50	28	15	150	180,4

The spacing isolator type DB/P has been tested for dynamic short-circuit withstand strength according to the regulations covering IEC 61439-1+2: 2009-01.

Short-circuiting resistance of the isolators Type DB/P

SHORT-CIRCUITING RESISTANCE / ISOLATOR DISTANCE - Tab. 1

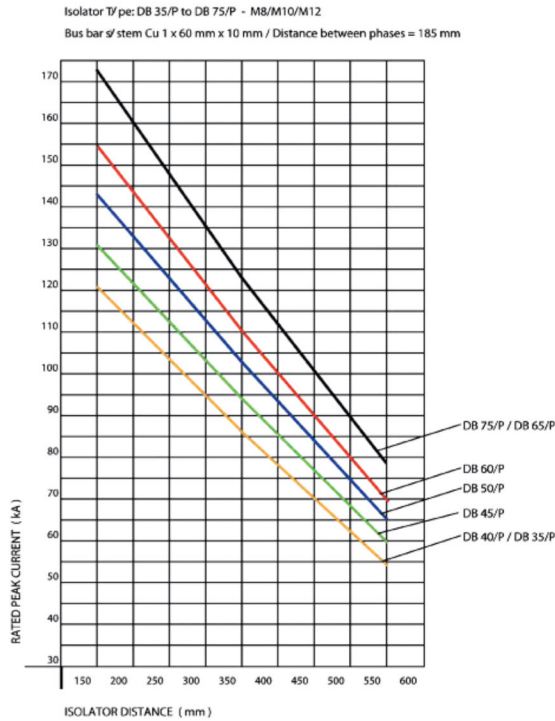

SHORT-CIRCUITING RESISTANCE / ISOLATOR DISTANCE - Tab. 2

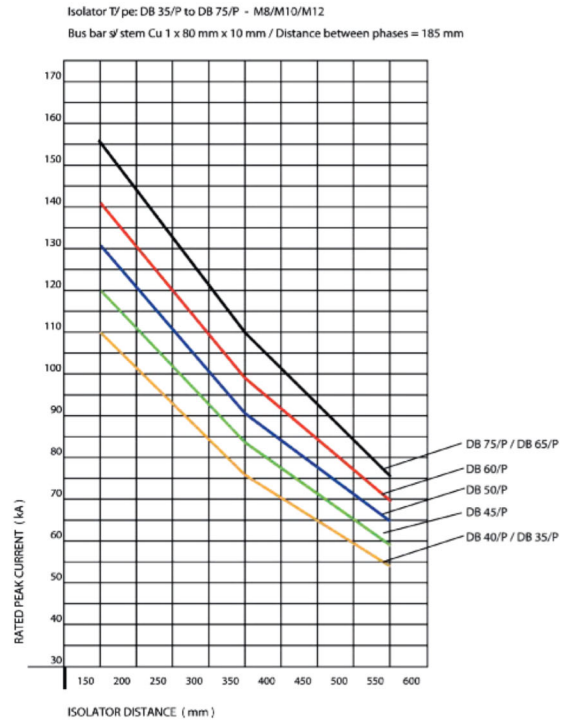

SHORT-CIRCUITING RESISTANCE / ISOLATOR DISTANCE - Tab. 3

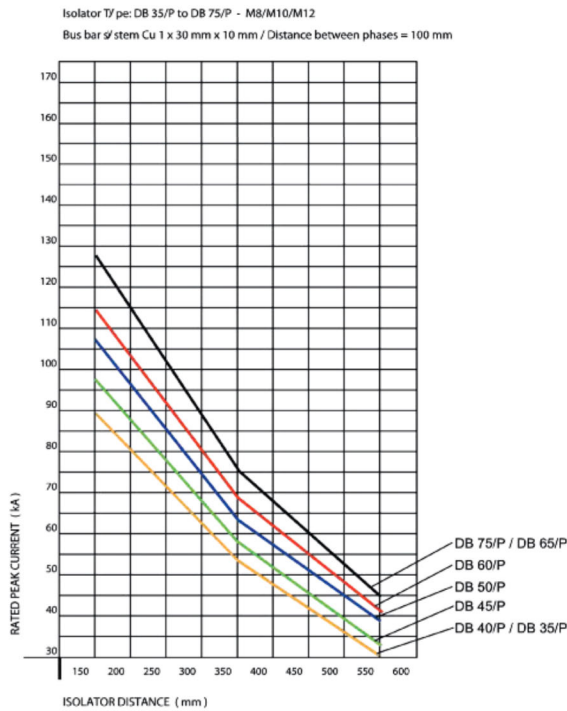

SHORT-CIRCUITING RESISTANCE / ISOLATOR DISTANCE - Tab. 4

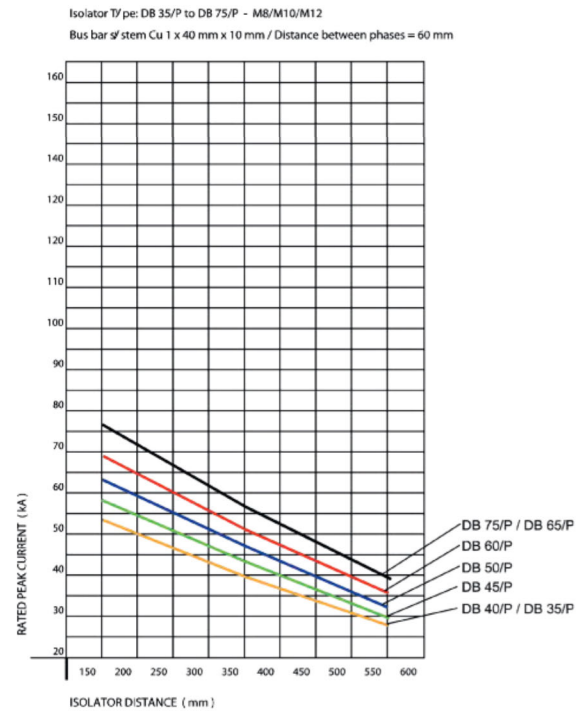



Independent, accredited testing station - Member laboratory of STL and LOVAG.

TEST REPORT

NO. 1469.2101265.0692

MBS AG Eisbachstraße 51 74429 Sulzbach-Laufen GERMANY	CLIENT
--	--------

Busbar systems: Distance Insulators:	ERIM SRL, Novate Milanese MBS AG	MANUFACTURER
---	-------------------------------------	--------------

Busbar systems for low-voltage switchgear assemblies with distance Insulators	TEST OBJECT
--	-------------

DB/P 50 with M10 & M12 threads	TYPE:
--------------------------------	-------

Test sample	SERIAL NO.
-------------	------------

Rated operational voltage	U_n	400 V	RATED CHARACTERISTICS GIVEN BY THE CLIENT
Rated insulation voltage	U_i	1000 V	
Rated peak withstand current:			
30 mm x 10 mm up to	I_{pk}	63 kA	
40 mm x 10 mm up to	I_{pk}	106 kA	
60 mm x 10 mm up to	I_{pk}	132 kA	
80 mm x 10 mm up to	I_{pk}	144 kA	
Rated frequency	f	50 Hz	

IEC 61439-2: 2009-01, EN 61439-2: 2009-11	NORMATIVE DOCUMENT
---	--------------------

Verification of dynamic short-circuit withstand strength	RANGE OF TESTS PERFORMED
--	--------------------------

12 to 14 October 2010	DATE OF TEST
-----------------------	--------------

See Sub-clause 4.6	TEST RESULT
--------------------	-------------

MICHAEL HEISE Test engineer in charge	RONALD BORCHERT Senior engineer Berlin, 25 November 2010



Independent test laboratory, accredited by Deutsche Akkreditierungsstelle Technik (DAKk) e.V. in the fields of fr. apparatus and switching, power cables and power cable accessories, fr. apparatus and switching, installation equipment and switching and control equipment.



DAT - P - 019/02



Unabhängiges, akkreditiertes Prüflaboratorium - Mitgliedsprüfamt bei STL und LOVAG.

PRÜFBERICHT

NR. 1469.2111429.0957

MBS AG Eisbachstraße 51 74429 Sulzbach-Laufen	AUFTRAGGEBER
---	--------------

MBS AG	HERSTELLER
--------	------------

Sammelschiensysteme für Niederspannungs-Schaltgerätekombinationen mit vertikalen Schienenhaltern Typ PSB, L & Z	PRÜFOBJEKT
---	------------

PSB/1, PSB/2, PSB/10, PSB/120, Distanzstück PSB, Schienenhalter L 100, Z 185-2	TYP
--	-----

90175, 90176, 90177, 90180, 28246, 90391, 90385	SERIEN-NR.
---	------------

Bemessungsbetriebsspannung	U_n	400 V	BEMESSUNGS-DATEN NACH ANGABEN DES AUFTRAGGEBERS
Bemessungsisolationsspannung	U_i	1000 V	
Bemessungsstoßstromfestigkeit	I_{pk}	bis zu 264 kA	
Bemessungskurzzeitstromfestigkeit	I_{kz}	bis zu 120 kA, 1s	
Bemessungsfrequenz	f	50 Hz	

IEC 61439-2: 2011-08, EN 61439-2: 2012-06	PRÜFVORSCHRIFT
---	----------------

Nachweis der Kurzschlussfestigkeit	UMFANG DER PRÜFUNG
------------------------------------	--------------------

16. und 17. August 2012	DATUM DER PRÜFUNG
-------------------------	-------------------

Siehe Punkt 4.6	PRÜFERGEBNIS
-----------------	--------------

MICHAEL HEISE Verantwortlicher Prüfmagister	RONALD BORCHERT Oberingenieur Berlin, den 30. November 2012



Unabhängiges Prüflaboratorium, akkreditiert von der DAKk, Deutsche Akkreditierungsstelle GmbH, für alle Bereiche Hochspannungstechnik, Anlagen und deren Komponenten, Kabel und Leitungen sowie industrieller Niederspannungstechnik.



ZERTIFIKAT CERTIFICATE CERTIFICADO CERTIFICAZIONE CERTIFICAZIONE CERTIFICATE CERTIFICATE CERTIFICATE



ZERTIFIKAT

Die Zertifizierungsstelle der TÜV SÜD Management Service GmbH bescheinigt, dass das Unternehmen



MBS AG
Eisbachstr. 51 • 74429 Sulzbach-Laufen
Deutschland

einschließlich der Standorte und Geltungsbereiche gemäß Anlage

ein Qualitätsmanagementsystem eingeführt hat und anwendet.
Durch ein Audit, Auftrags-Nr. 70003062, wurde der Nachweis erbracht, dass die Forderungen der

ISO 9001:2015

erfüllt sind.

Dieses Zertifikat ist gültig vom 05.04.2019 bis 04.04.2022.
Zertifikat-Registrier-Nr.: 12 100 20346 TMS.



Product Compliance Management
München, 08.04.2019



Seite 1 von 2

TÜV SÜD Management Service GmbH • Zertifizierungsstelle • Fidlerstrasse 57 • 80329 München • Germany
www.tuev-sued.de/certificate-validity-check

