

# Hammerset anchor EA II

The internally threaded anchor with rim for simple hammerset installation

4



Pipelines

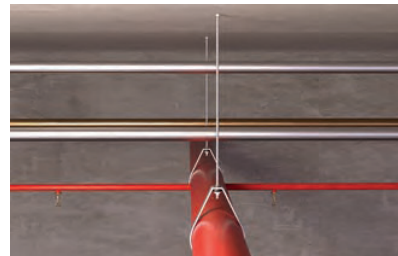

Sprinklers

## Applications

- Pipelines and ventilation ducts
- Sprinkler systems
- Cable conduits and wires
- Gratings
- Steel constructions
- Machines
- Consoles
- Shuttering props
- Diamond or core drilling devices (EA II M12 D)

## Certificates



ETA-07/0135, for non-cracked concrete  
ETA-07/0142, for non-structural applications in concrete



Fire resistance classification R120



from M10



INOX STAINLESS STEEL



from M8

## Advantages

- The embossed rim prevents the anchor sleeve from slipping, thus ensuring a trouble-free hammerset installation.
- The metric internal thread means that it is possible to use standard screws or threaded rods for the ideal adaptation to suit the intended use.
- The EMS machine setting tool allows for effortless installation, particularly in the case of series installations.
- The embossing that is applied when

expanding with the EHS Plus setting tool offers a simple control of the anchoring and provides increased safety.

- Fixing point at  $h_{ef}$  25 mm prevents anchor of falling out of the drill hole before being expanded.
- The black fixing point prevents the anchor from falling out of the drill hole during overhead installation.

## Building materials

Approved for:

- Concrete C20/25 to C50/60, cracked, for the multiple fixings of non-load-bearing systems
- Concrete C20/25 to C50/60, non-cracked

Also suitable for:

- Concrete C12/15
- Natural stone with dense structure

## Versions

- Zinc-plated steel
- Stainless steel R

## Functioning

- The EA II is suitable for pre-positioned installation.
- Position the hammerset anchor in the drill hole and drive in flush to the surface of the anchor base using the hammer.
- The sleeve is then expanded by driving in the internal bolt with the EHS Plus setting tool (alternative: EMS machine setting tool), and expanded against the drill hole wall.
- The setting tools must sit on the rim of the anchor to ensure correct expansion.
- Use the special EA II M12 x 50 D / EA M12 x 50 N D with thicker sleeve for fixing diamond and core drilling devices.

Installation EA II

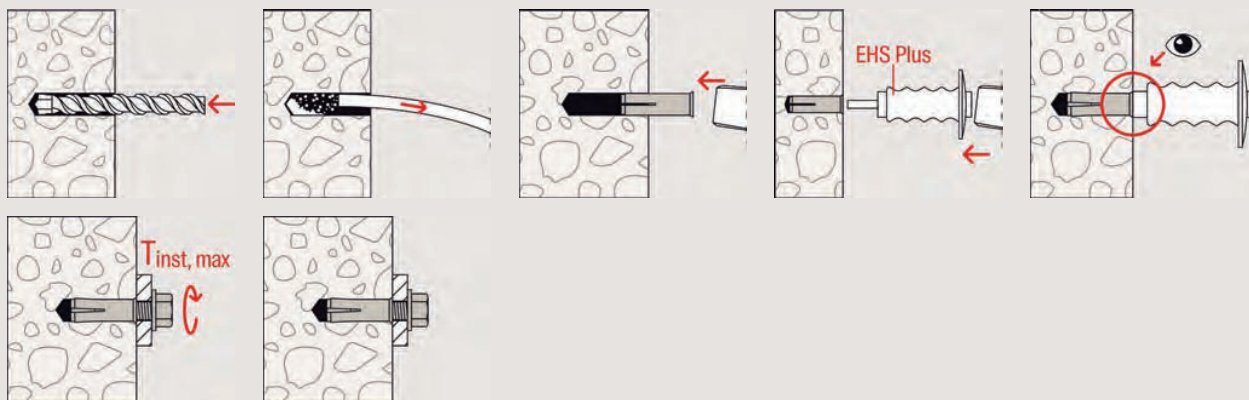

4

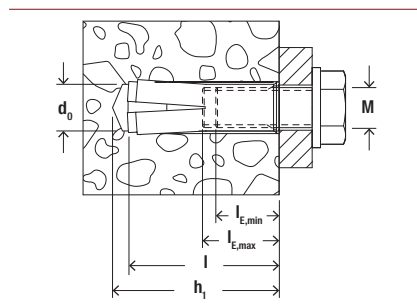

Technical data

Hammerset anchor EA II



EA II with reduced anchorage depth  $h_{ef}$  25 mm and a black fixing point which prevents the anchor from falling out of the drill hole



EA II not suitable for diamond drilling appliances and diamond saws

Item	Zinc-plated steel	Stainless steel	Approval	Drill hole diameter	Min. drill hole depth for pre-positioned installation	Anchor length	Internal thread	Min. bolt penetration	Max. bolt penetration	Sales unit
	Item No.	Item No.		$d_0$ [mm]	$h_1$ [mm]	$l$ [mm]		M	$l_{E,min}$ [mm]	
EA II M 6 x 25	532230	—	●	8	27	25	M 6	6	14	100
EA II M 6 x 30	048264	048410	●	8	32	30	M 6	6	14	100
EA II M 8 x 25	532231	—	●	10	27	25	M 8	8	14	100
EA II M 8 x 30	048284	048411	●	10	33	30	M 8	8	14	100
EA II M 8 x 40	048323	048412	●	10	43	40	M 8	8	14	50
EA II M 10 x 25	532232	—	●	12	27	25	M 10	10	14	50
EA II M 10 x 30	048332	—	●	12	33	30	M 10	10	14	50
EA II M 10 x 40	048339	048414	●	12	43	40	M 10	10	17	50
EA II M 12 x 25	532233	—	●	15	27	25	M 12	12	14	25
EA II M 12 x 50	048406	048415	●	15	54	50	M 12	12	22	25
EA II M 16 x 65	048408	048416	●	20	70	65	M 16	16	28	20
EA II M 20 x 80	048409	048417	●	25	85	80	M 20	20	34	10