

# Threaded rod M10 3 m

In order to get an adjustment of  $\pm 25$  mm in combination with the threaded rod bracket, cut the pendant as follows: 50-75 mm 90 mm shorter than the required inset height. 100-600 mm 50 mm shorter than the required inset height.

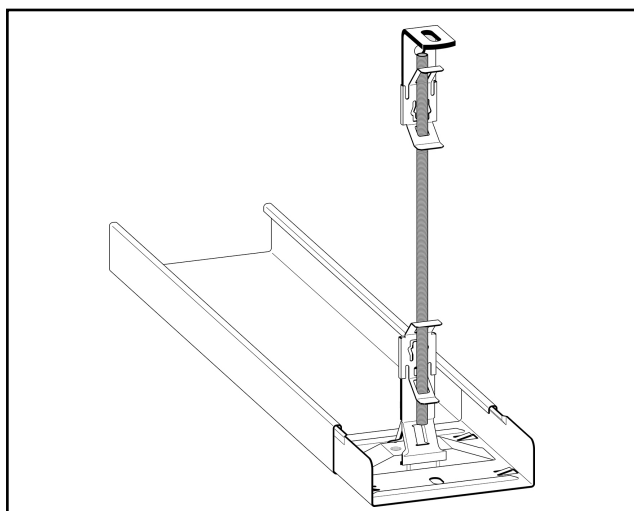
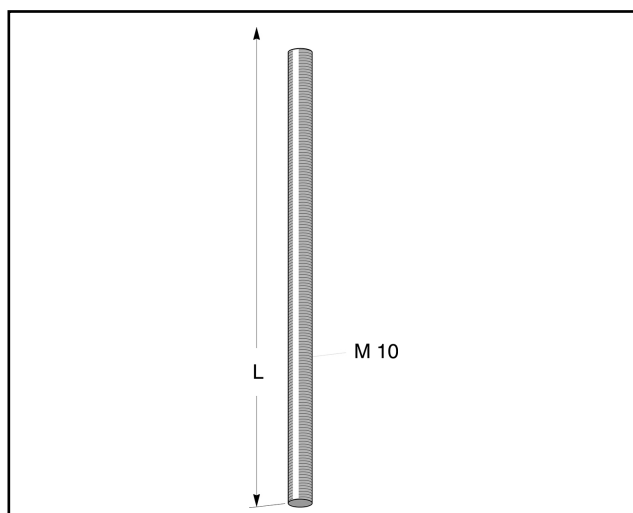
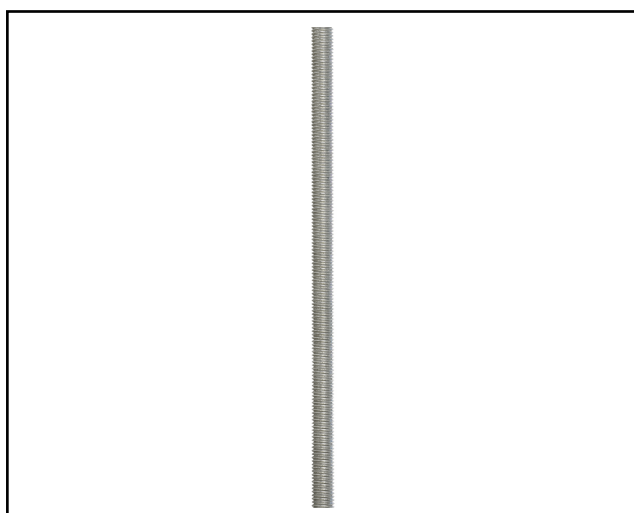

MP-no	GTIN	Dimension (LxBxH) mm	Weight kg	Surface	Max env. class	Pieces/ pack.
928E	7394333123363	3000x10x10	1.50	Electro-galvanized 10 $\mu$ m	C1	20