



ZK235-11Z-M20

- Metal enclosure
- 30 mm x 63,5 mm x 30 mm
- 1 Cable entry M 20 x 1.5
- Mounting details to EN 50047
- Wide range of alternative actuators
- Good resistance to oil and petroleum spirit
- Actuator heads can be repositioned by 4 x 90°
- Snap action with constant contact pressure up to switching point

Data

Ordering data

| | |
|-------------------------------|---------------|
| Product type description | ZK 235-11Z |
| Article number (order number) | 101164307 |
| EAN (European Article Number) | 4030661205458 |
| eCl@ss number, Version 9.0 | 27-27-26-01 |

Certifications

| | |
|--------------|---------------------|
| Certificates | cULus CCC EAC |
|--------------|---------------------|

General data

| | |
|--------------------------------------|---|
| Product name | Z 235 offset roller lever K |
| Standards | IEC 60947-5-1 ISO 13849-1 BG-GS-ET-15 |
| Housing construction form | Norm construction design |
| Actuator type to DIN EN 50047 | E |
| Enclosure material | Zink |
| Enclosure coating material | painted |
| Material of the contacts, electrical | Silver |
| Weight | 155 g |

General data - Features

| | |
|------------------------------|-----|
| Safety functions | Yes |
| Number of auxiliary contacts | 1 |
| Number of safety contacts | 1 |

Safety appraisal

| | |
|--------------|-------------|
| Standards | ISO 13849-1 |
| Mission Time | 20 Year(s) |

Safety appraisal - Safety outputs

| | |
|-----------------------------------|-----------------------|
| B10d Normally-closed contact (NC) | 20,000,000 Operations |
|-----------------------------------|-----------------------|

Mechanical data

| | |
|-------------------------------|---|
| Actuating element | Offset roller lever |
| Mechanical life, minimum | 20,000,000 Operations |
| Actuating force, minimum | 9 N |
| Positive break force, minimum | 19 N |
| Actuating speed, minimum | 24 mm/min |
| Actuating speed, maximum | 1 m/s |
| Note (Actuating speed) | Actuating speed with actuating angle 30° to switch axis |

Mechanical data - Connection technique

| | |
|------------------------|---|
| Terminal Connector | Screw connection |
| Cable section, minimum | 0.75 mm ² |
| Cable section, maximum | 2.5 mm ² |
| Note (Cable section) | All indications about the cable section are including the conductor ferrules. |

Mechanical data - Dimensions

| | |
|------------------|---------|
| Height of sensor | 95.1 mm |
| Length of sensor | 30 mm |
| Width of sensor | 30 mm |

Ambient conditions

| | |
|------------------------------|--------|
| Protection class | IP67 |
| Ambient temperature, minimum | -30 °C |
| Ambient temperature, maximum | +80 °C |

Ambient conditions - Insulation value

| | |
|---------------------------------|------|
| Rated impulse withstand voltage | 6 kV |
|---------------------------------|------|

Electrical data

| | |
|--|------------------------|
| Thermal test current | 10 A |
| Required rated short-circuit current to EN 60947-5-1 | 1,000 A |
| Utilisation category AC-15 | 230 VAC |
| Utilisation category AC-15 | 4 A |
| Utilisation category DC-13 | 24 VDC |
| Utilisation category DC-13 | 1 A |
| Switching element | NO contact, NC contact |
| Switching principle | Snap switch element |
| Bounce duration, maximum | 3 ms |
| Switching frequency | 5,000 /h |
| Switchover time, minimum | 5.5 ms |

Documents**Operating instructions and Declaration of conformity****EC Declaration of conformity****UL Certificate****CCC certification**

EAC certification

SISTEMA-VDMA library

Pictures

Product picture (catalogue individual photo)



ID: k235kf01

| 342,4 kB | .jpg | 113.594 x 282.575 mm - 322 x 801 Pixel - 72 dpi
 | 3,4 kB | .jpg | 35.278 x 35.278 mm - 100 x 100 Pixel - 72 dpi
 | 336,1 kB | .jpg | 112.889 x 280.811 mm - 320 x 796 Pixel - 72 dpi
 | 187,1 kB | .png | 74.083 x 184.15 mm - 210 x 522 Pixel - 72 dpi

Dimensional drawing basic component

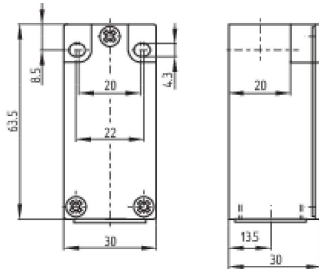

ID: 1-235g01

| 24,6 kB | .cdr |
 | 4,0 kB | .png | 74.083 x 61.383 mm - 210 x 174 Pixel - 72 dpi
 | 28,5 kB | .jpg | 112.889 x 93.839 mm - 320 x 266 Pixel - 72 dpi
 | 3,6 kB | .jpg | 35.278 x 35.278 mm - 100 x 100 Pixel - 72 dpi
 | 114,7 kB | .jpg | 352.778 x 293.158 mm - 1000 x 831 Pixel - 72 dpi

Switch travel diagram

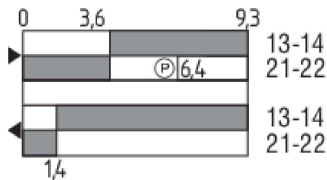

ID: kk235s18

| 2,5 kB | .png | 74.083 x 39.864 mm - 210 x 113 Pixel - 72 dpi
 | 27,5 kB | .cdr |
 | 22,1 kB | .jpg | 112.889 x 61.031 mm - 320 x 173 Pixel - 72 dpi

Diagram

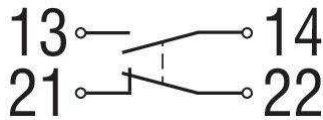

ID: k1o1sk01

| 18,4 kB | .jpg | 112.889 x 45.861 mm - 320 x 130 Pixel - 72 dpi

Dimensional drawing actuator

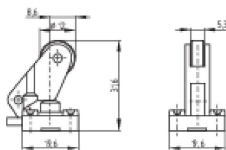

ID: 1k236g01

| 3,6 kB | .png | 74.083 x 51.506 mm - 210 x 146 Pixel - 72 dpi
 | 60,3 kB | .cdr |
 | 67,4 kB | .jpg | 352.778 x 245.886 mm - 1000 x 697 Pixel - 72 dpi

System components

PS215 offset roller lever K200

103014958 PS215-Z11-K200



- Metal enclosure
- Design to EN 50047
- Quick connection technology as connection terminals rotated by 45°
- Simple and quick to adjust the control elements by 45°.
- cable entry 1 x M20 x 1,5

K.A. Schmersal GmbH & Co. KG, Möddinghofe 3, D-42279 Wuppertal

The details and data referred to have been carefully checked. Images may diverge from original. Further technical data can be found in the manual. Technical amendments and errors possible.

Generated on 31.03.2020 17:46:02