

## ASRD 14

### Three-phase current transformer set

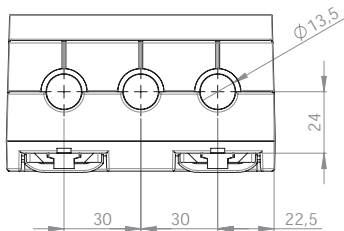

Round conductor 13,5 mm  
 Transformer width 105 mm  
 Height 90 mm  
 Depth 54 mm

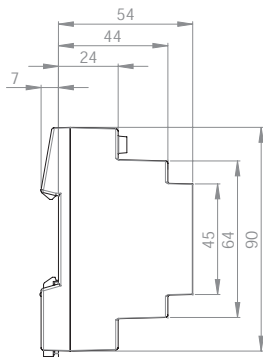
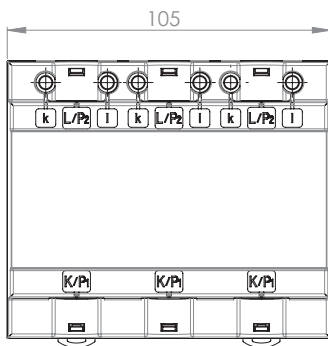

Primary current [A]	Burden [VA]	Secondary current [A] / Class			
		5 A Cl. 1 Art.-no.	5 A Cl. 0,5 Art.-no.	1 A Cl. 1 Art.-no.	1 A Cl. 0,5 Art.-no.
3 x 50	1	96030		96230	
<b>3 x 60</b>	<b>1,25</b>	<b>96032</b>		96232	
3 x 75	1,5	96034		96234	
3 x 80	1,5	96036		96236	
3 x 100	2,5	96038		96238	
3 x 125	2,5	96039	96014	96239	96214
3 x 150	2,5	96040	96017	96240	96217
	3,75	96044		96244	

		Art.-no.
	<b>Snap-on mounting</b>	-
	<b>Sealed shutter</b>	-